

Technical Specs:

Insulator: Black glass filled polyester PPS-GF30-FR
Flammability: UL 94V-0
Sleeve: Brass
Contact clip(6 finger): Beryllium copper(C17200)
Accepted pin: Ø0.70 to 0.90mm, 0.635mm
Forces: (polished steel gauge Ø0.76mm)
 --Insertion 2 N typ
 --Withdrawal 1 N typ
Mechanical life: min500 cycles
Rated current: 3A
Contact resistance: max 10mΩ
Dielectric resistance: Min 1000V RMS
Coplanarity SMD max 0.1mm(measured on terminations: 25mm long connectors)

Ordering Information

3620 70 X XX S XX 100 01

Insulator Type
 Code
 1:Single row
 2:Double row
No. of Pins
 1-40Pin
Contact Plating
 G0:Gold Flash
 S0:Gold Flash/Tin
 S4:5u"Gold/Tin
 S5:10u"Gold/Tin
 S6:30u"Gold/Tin
Length
 100=10.0mm

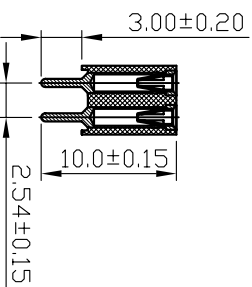
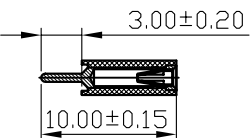
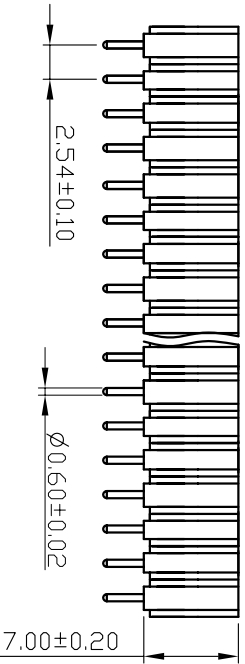
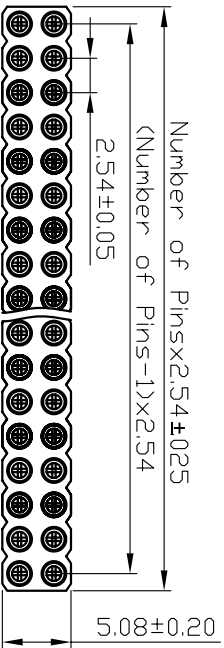
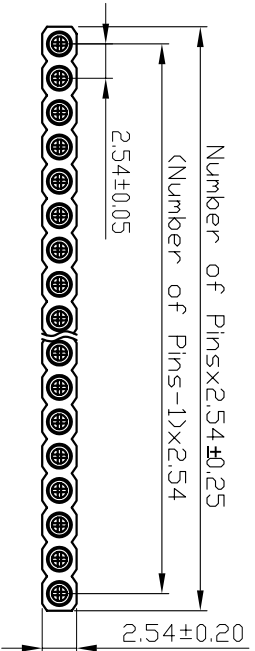

JILN ELECTRONIC CO.,LTD

PART NO. 3620702XX23S10001

TITLE: 2.54X7.0mm孔座2XNNPIN L=10.0

REV	DATE	MODIFICATION DESCRIPTION	CHANGE	OPERATION		DRAW	WZG	14.05.30	SCALE		FIT
				X.X	±0.30				UNIT	mm	
A0	2014.05.30	NEW DRAWING		X.XX	±0.20	CHECK			SIZE	A4	
				Angle	±3°	APPROVE			SHEET	1/1	
				DIM	TOL				PROJ.		

1 2 3 4 5 6 7 8 9